

Delivery Management Plan

Proposed Happy Days , Corinthian Park, Cheltenham

Prepared for Hinton Properties

May 2018



DDP

**DESIGN
DEVELOPMENT
PARTNERSHIP**

Contents

Introduction

1.1 Background

1.2 Existing layout

Delivery Management Strategy

2.1 Service Deliveries

2.2 Refuse and Recycling Collections

2.2 Good Neighbour and Operational

Conclusions

Appendix A – Development Masterplan

Appendix B - Proposed Site layout and delivery tracking

Introduction

1.1 Development Proposals

The application comprises a hybrid planning application split into two parts to reflect two development phases;

Detailed planning permission is sought for the following:

Two B1 office buildings (5,034sq.m. GIA) with ancillary parking;
A1 / A3 Costa Coffee drive thru (204sq.m. GIA);
A1 Aldi discount food retail (1,742sq.m. GIA); and
D1 day nursery (502sq.m. GIA).

Outline planning permission is sought for the following:

Two B1 office buildings (8,034sq.m. GIA) with ancillary parking.

The development masterplan is included at **Appendix A**.

1.2 Existing Layout

The site is in the South West area of Cheltenham. It is in an area that comprises residential, employment and retail uses.

Grovefield Way forms the eastern boundary of the site and connects to Hatherley Lane and the A40 in the north, and with Cold Pool Lane and The Reddings in the south. It is a single carriageway road, which is illuminated and subject to a 40mph speed limit.

Grovefield Way joins Hatherley Lane and forms a priority junction onto the partially signalised Arle Court Roundabout on the A40 to the east of the site. A second roundabout is located to the immediate south of the Arle Court Roundabout and this connects Grovefield Way to Hatherley Lane, as well as providing access to the B&Q Superstore and the Arle Court Park and Ride.

The A40 connects Gloucester in the west with Cheltenham in the east and is known locally as Gloucester Road. The A40 is a dual carriageway road in the vicinity of the site, which is subject to the national speed limit of 70mph.

Junction 11 of the M5 motorway is located approximately two kilometres to the west of the site by road and is a grade separated, priority controlled roundabout junction.

The site access road and its junction with Grovefield Way have been agreed in principle with the local highway authority as part of the consented B1 use on the wider site. The site access junction on Grovefield Way and an approximate 160 metre section of the access road has been constructed as part of the BMW Mini car showroom development up to the boundary of the BMW site. This access road will be extended into the application site, as shown on the masterplan at **Appendix A**.

Delivery Management Plan

2.1 Service Deliveries

Deliveries will take place with the vehicles unloading in front of the nursery entrance as demonstrated in **Appendix B**.

It is forecast that the proposed store would require one weekly food delivery. Deliveries will be made by a box van, the type typically used for grocery store home deliveries. There will also be twice monthly deliveries of nursery supplies made by a standard transit van.

Deliveries will be carried out in accordance with the recommendations set out in the Noise Impact Assessment produced by Hoare Lea and will take place between the opening hours of 07.00 and 19.00 Monday to Friday.

2.2 Refuse and Recycling Collections

Refuse and recycling collections will be carried out twice a week and will be fulfilled through private collection.

The bin store is located adjacent to the South-East corner of the building and refuse vehicles will utilise the route as demonstrated in **Appendix B**.

2.3 Good Neighbour and Operational Safety Practises

Goods delivery is a one-man function carried out by the driver. The standard delivery period is
10-15 minutes;

The following practise will be implemented:

Keep noise to a minimum
Switch off the engine, fridge and radio
The considerate closing of doors (do not slam)

The standard safety practices for both the driver and store staff will be observed. These include:

All relevant PPE is worn during delivery (boots, jackets, gloves)
Audible and visible warning devices to be used
Hi-viz to be worn in all areas at all times
Only trained persons to be involved
An awareness of the risks (a risk assessment)

Conclusions

Weekly deliveries will take place between 07.00 and 19.00 Monday to Friday. Deliveries and collections will take place directly in front of the store entrance and waste will be collect from the bin store adjacent to the South-East corner of the building as demonstrated in **Appendix B**. The delivery vehicles will be fitted with up-to-date technology that minimises noise and delivery staff will receive guidance on good practise procedures to ensure that noise is kept to a minimum during deliveries and collections.

REV	DATE	DESCRIPTION	CHECKED BY
A	06.12.16	REVISED SITE PLAN	L.T
B	27.01.17	REVISED SITE PLAN	D.W
C	07.02.17	REVISED SITE PLAN	L.T
D	31.07.17	REVISED SITE PLAN	L.T
E	21.09.17	REVISED SITE PLAN UPDATED VEHICLE TRACKING	L.T

- Preliminary
 Comment
 Record
 Tender
 Construction
 Legal

© This drawing/disk and the works depicted are the copyright of Design Development Partnership Ltd and may not be reproduced or amended except by written permission. No liability will be accepted for amendments made by other persons.
 All drawings and specification to be read in conjunction with Structural Engineer and other consultants drawings.
 All discrepancies should be reported to the architect.
 Figured dimensions only are to be taken from this drawing
 *Drawing subject to topographical survey

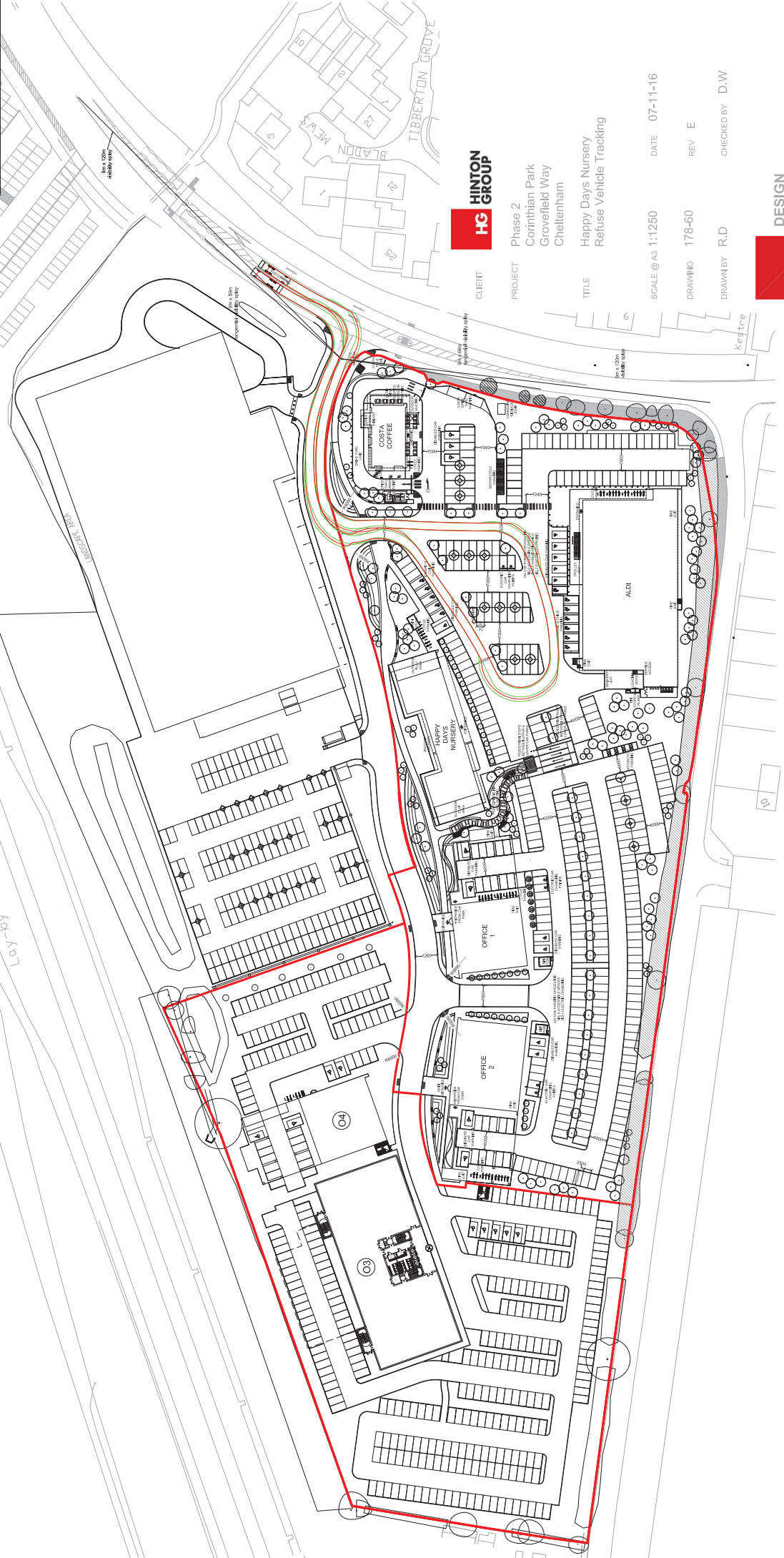
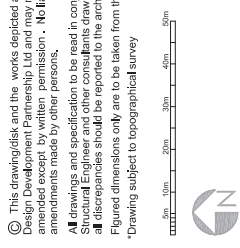

HG HINTON GROUP
 CLIENT
 PROJECT Phase 2
 Cortinhan Park
 Grovefield Way
 Cheltenham
 TITLE Happy Days Nursery
 Refuse Vehicle Tracking
 SCALE @ A3 1:1250
 DATE 07-11-16
 DRAWING 178-60
 REV E
 DRAWNBY R.D
 CHECKED BY D.W



DDP
 DESIGN
 DEVELOPMENT
 PARTNERSHIP

ARCHITECTURE + PLANNING + PRINCIPAL DESIGNER

A: Reims House, 8 The Croft, Bunsford Drive, Bromsgrove, B60 4JE
 T: 01527 878 200
 F: 01527 878 201
 E: mail@ddpdesign.co.uk
 W: www.hintongroup.co.uk

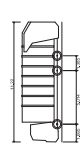

Format: A3
 Plotter: Recycle P5500 with file box (check)
 Overall width: 1170mm
 Overall height: 840mm
 Overall length: 1190mm
 Plot scale: 1:1250
 User: K.M. (p.e.)
 Date: 21/09/17
 Plot to: 1170mm x 840mm