

© This drawing/disk and the works depicted are the copyright of Design Development Partnership Ltd and may not be reproduced or amended except by written permission. No liability will be accepted for amendments made by other persons.

All drawings and specification to be read in conjunction with Structural Engineer and other consultants drawings; all discrepancies should be reported to the architect.

Figured dimensions only are to be taken from this drawing

\*Drawing subject to topographical survey



- Preliminary     Comment     Planning
- Tender     Construction     Record
- Legal

REVISIONS			
REV	DATE	DESCRIPTION	CHECKED BY
A	05.12.16	-SCALE BAR ADDED.	L.T
B	06.12.16	-SCALE BAR AMENDED.	L.T

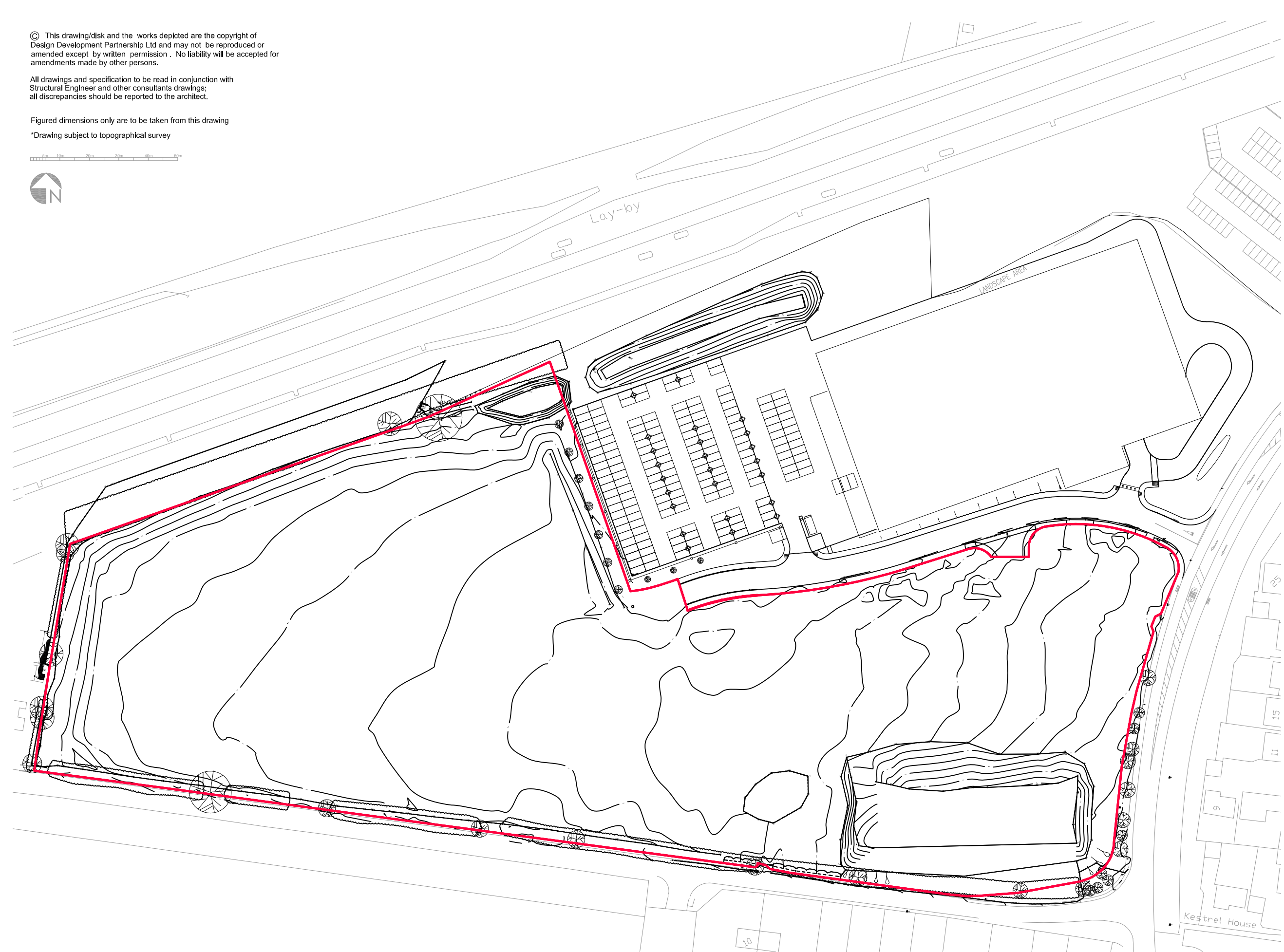

CLIENT **HG HINTON GROUP**

PROJECT Phase 2  
Corinthian Park  
Grovefield Way  
Cheltenham

TITLE Existing Site Plan

SCALE @ A3 1:1250    DATE 24-11-16

DRAWING 178-71    REV A

DRAWN BY R.D    CHECKED BY D.W

**DDP** DESIGN DEVELOPMENT PARTNERSHIP

ARCHITECTURE + PLANNING + PRINCIPAL DESIGNER

A: Reims House, 8 The Croft, Buntsford Drive, Bromsgrove, B60 4JE  
T: 01527 571 785  
F: 01527 878 207  
E: mail@ddpdesign.co.uk  
W: www.hintongroup.co.uk