

**Legend**

	Existing vegetation - boundary hedgerow and trees		Proposed hedge
	Proposed native buffer planting on a 0.5m Grid		Proposed grass sward
	Proposed native buffer planting on a 1.0m Grid		Existing grass verge
	Proposed evergreen tree planting Trees planted within 3m of hard landscaping surface of underground services will be planted with root director barrier. Green Blue Urban Re-Root 2000 or Re-Root 600		Gravel surface refer to hard proposals
	Proposed deciduous tree planting Trees planted within 3m of hard landscaping surface of underground services will be planted with root director barrier. Green Blue Urban Re-Root 2000 or Re-Root 600		Pebble surface refer to hard proposals
	Proposed shrub planting		Gabions refer to hard proposals
	Application boundary		

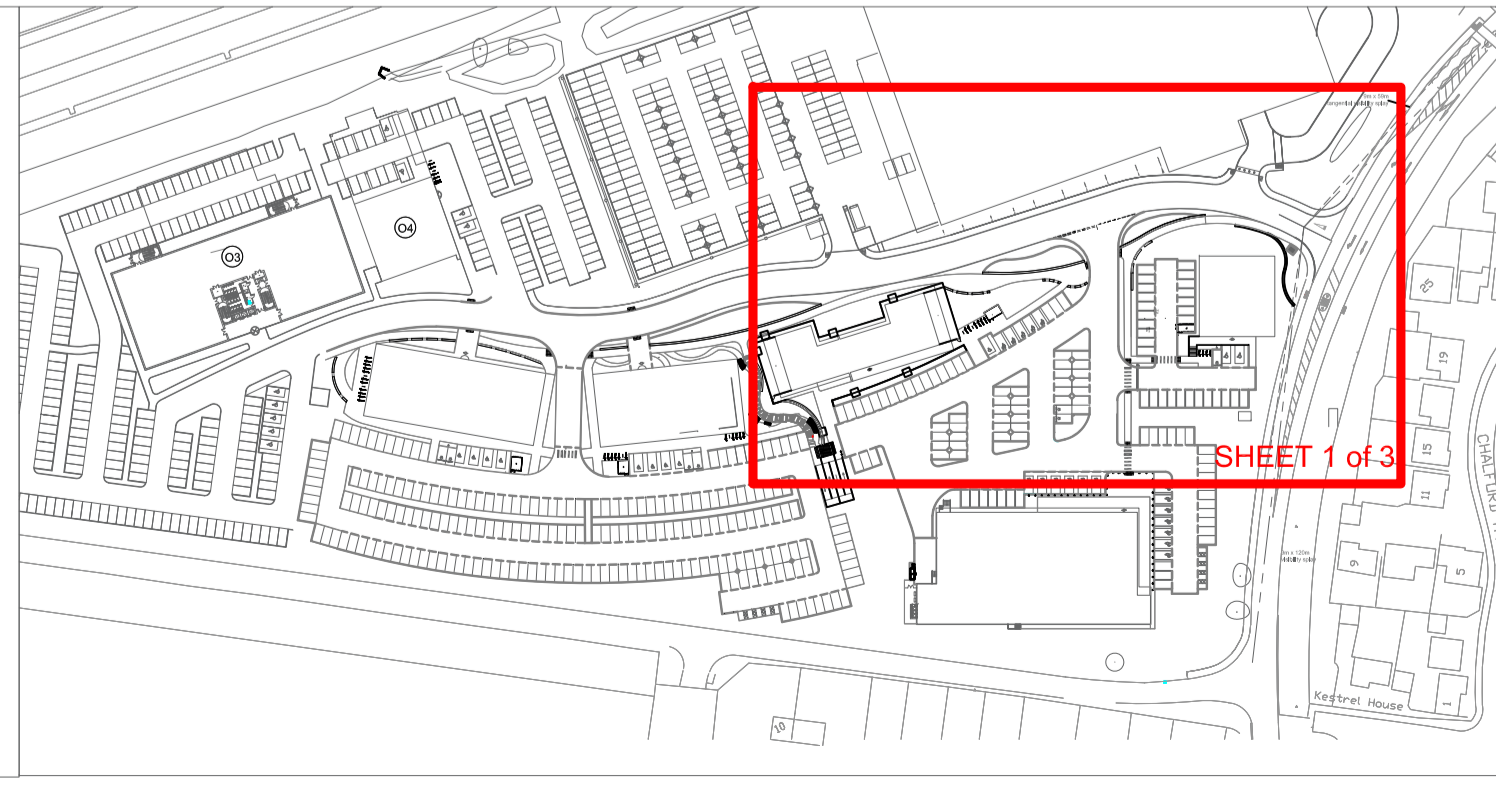
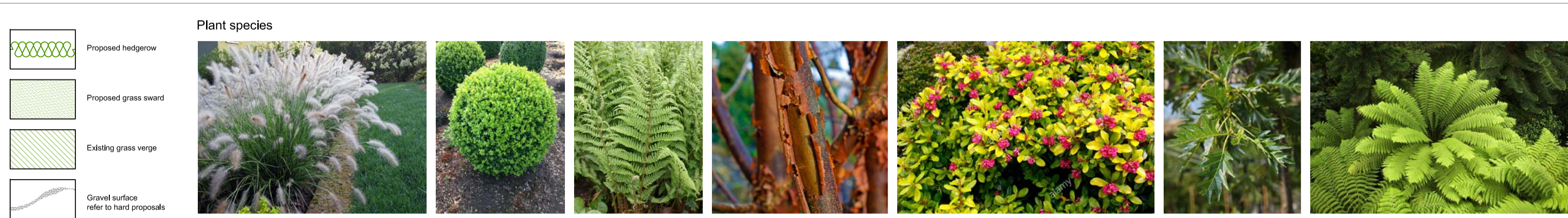

Mark	Date	Details	By
E	20/09/2018	Amendments to GA plan	MG
D	28/10/2017	Minor amendments	MG
C	23/06/2017	Add lobby removed	MG
B	22/06/2017	Planting quantities added	HK
A		Details	By

Client:  
**Hinton Group**

Project Title:  
**Corinthian Park, Cheltenham  
Phase 2**

Scale: 1:200 for the original size of A1

Drawn by: MG Checked by: - Passed by: MG Date: 20.09.2018

Drawing Status:  
**Planning**

Drawing Originator:  
**DAVIESLANDSCAPE ARCHITECTS**  
Suite F1, Stroud House, Russell Street, Stroud, Gloucestershire, GL5 3AN  
t. 01453 760380 e. info@d4h.co.uk w. www.d4h.co.uk

Drawing Title:  
**Planting Proposals (sheet 1 of 3)**

Job No.	Client	Project	Origin	Volume	Level	Type	Check	Number	Created
1755	D4A	-	-	-	-	P	L	09	11

DO NOT SCALE FROM THIS DRAWING

Customer Data Protection Policy: [www.davieslandscape.co.uk/privacy-policy](#)  
 Davies Landscape Architects Limited is a registered company in England and Wales.  
 Registered Office: Suite F1, Stroud House, Russell Street, Stroud, Gloucestershire, GL5 3AN  
 Registered in England and Wales: 08449872  
 VAT No: 258 240 845  
 Company No: 06449872