

Preliminary Planting Proposals  
Unwins Fountain, Sandford Park, Cheltenham  
for  
Cheltenham Borough Council



**European Union**  
European Regional  
Development Fund



Linda Thomas CMLI JFRI MA Garden History  
Chartered Landscape Architect and Consultant

Aerial photograph of site as existing  
NB west and north facing planting beds in light shade from trees

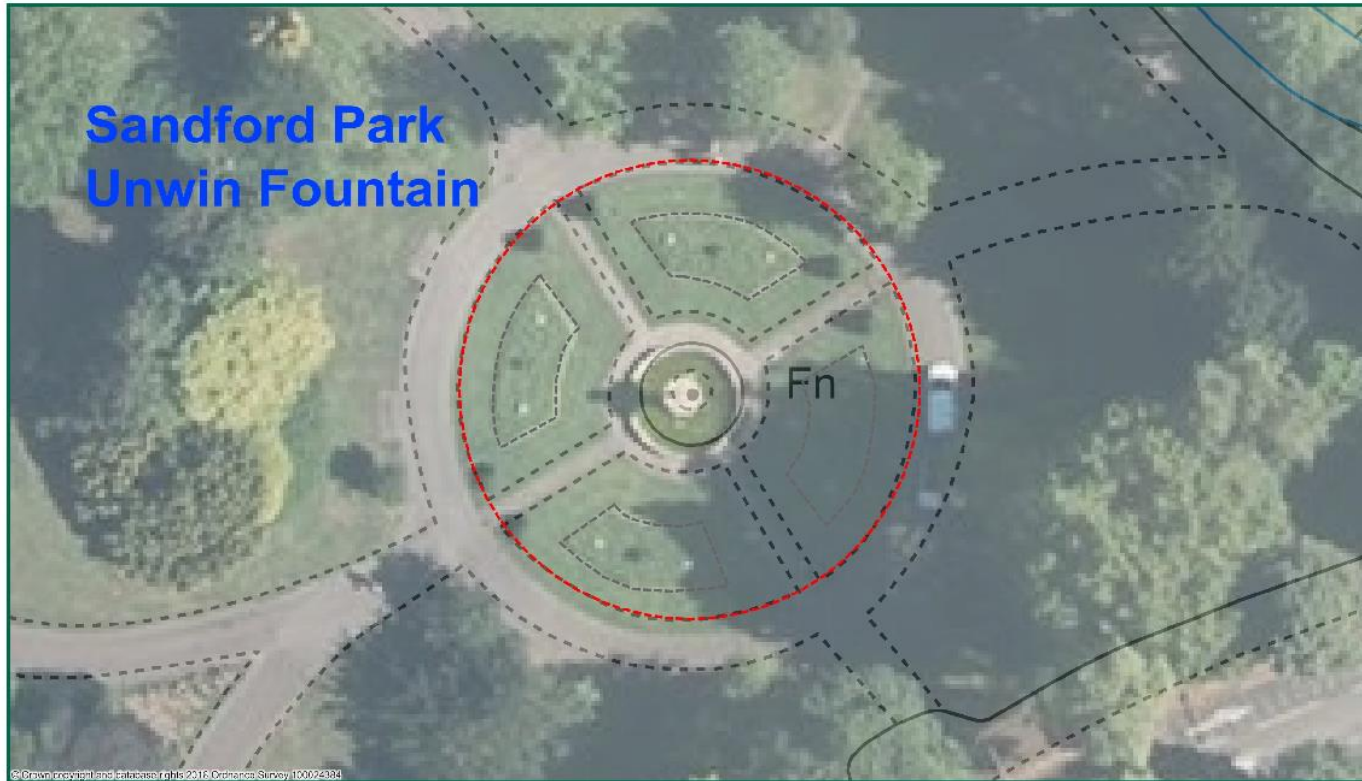

## LEGEND

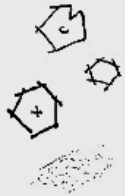

Diseased/damaged box topiary to be removed including roots

Chusan palm in bedding area to be removed

Proposed specimen trees in grass to be planted Nov-March

Proposed edging to planted area: excavate to 50mm depth; lay geotextile matting and spread 40mm Welsh blue slate chips flush with path

## NOTES:

1. Turfed areas to be removed offsite by hand (NOT rotovated) and all weeds and their roots eradicated.
2. Proposed planted areas to be kept weedfree prior to planting.
3. Soil cultivated to minimum 300mm depth.
4. Add mushroom compost and well rotted farmyard manure if available. Organic material to be added as a layer approx. 300mm depth.
5. Tree planting pits prepared and backfilled with compost Nov-March
6. Proposed evergreen topiary trees and low hedge to be planted during dormant season Nov - March
7. Retain existing path edgings to quadrants i.e timber edging adjacent outer circle; metal edging to other three sides.
8. Carry out regular removal of weeds after planting.
9. Key to success; keep perennials well watered in the first year of establishment, even those considered drought tolerant.
10. Snowdrops and winter aconites to be planted 'in the green' i.e end of March.

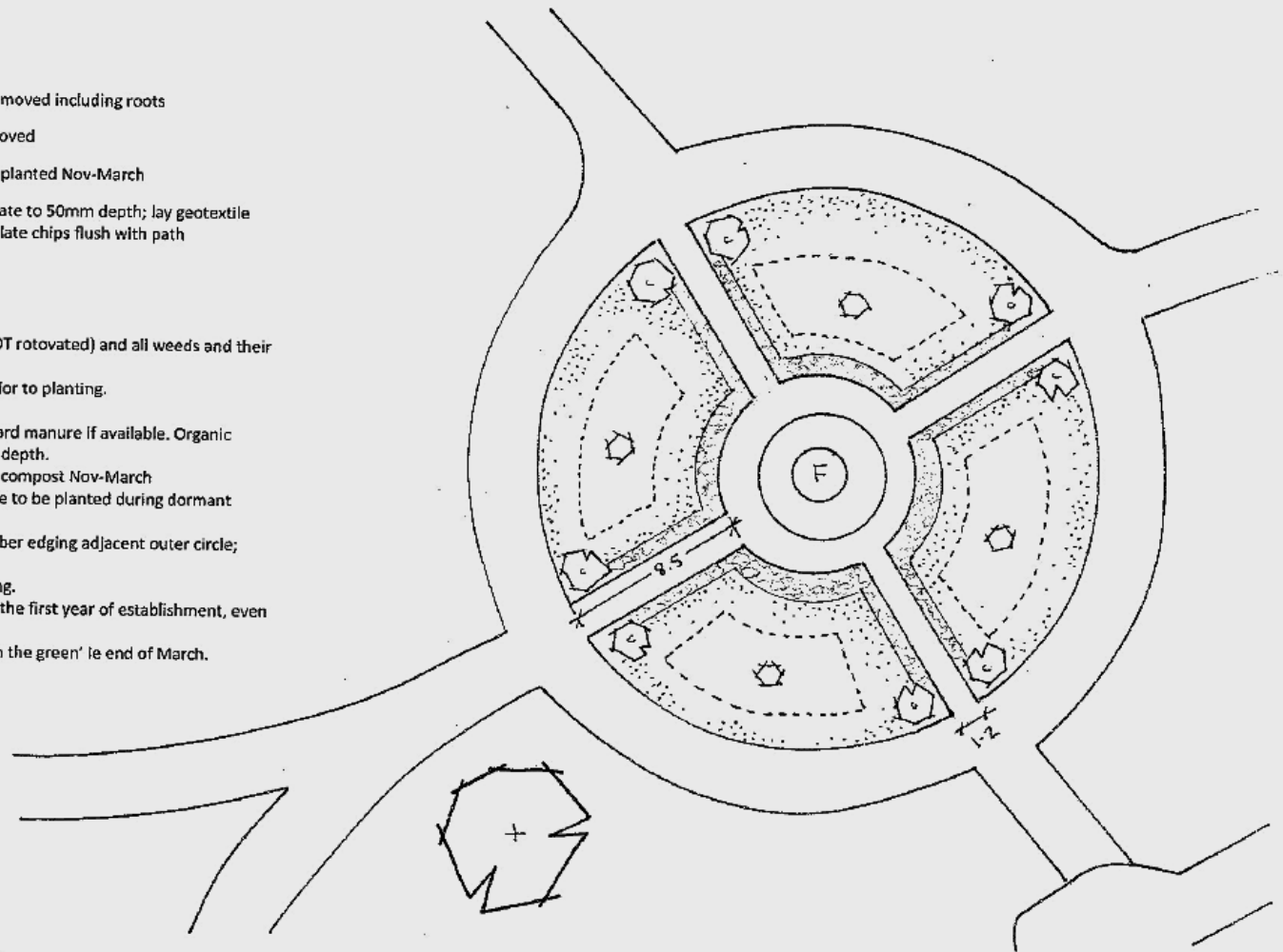

## Sandford Park - Unwin Fountain Red line - scope area



European Union  
European Structural  
and Investment Funds

© Crown copyright and database rights 2018 Ordnance Survey 100024064

Project: Unwins Fountain, Sandford Park, Cheltenham

Title: Preparatory Works



Scale: approx. 1:200 (Do not scale from this drawing)

Date: August 2018





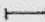

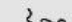

Linda Thomas CMLJFRI MA Landscape Consultant ©

**LEGEND**

**Existing**

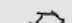
-  Grassed areas
-  Bench (indicative location only)
-  Concrete plinth suitable for a new bench or art feature

**Proposed**

-  Perennial planting
-  Low evergreen hedge c 300mm max height
-  Evergreen fastigiate tree max 3.00m height
-  Feature ornamental grass max 1.50m height
-  Feature standard: deciduous shrub with flower colour
-  Feature evergreen shrub max 1.50m height
-  Feature deciduous tree max 8.00m height
-  Edging to planted border: 40mm blue slate chips



**Sandford Park - Unwin Fountain  
Red line - scope area**



© Crown copyright and database rights 2018 Ordnance Survey 100024384

Project: Unwins Fountain, Sandford Park, Cheltenham  
Title: Main Planting Layout  
Scale: approx. 1:200 (Do not scale from this drawing)  
Date: August 2018  
Linda Thomas CMLI JFRI MA Landscape Consultant ©

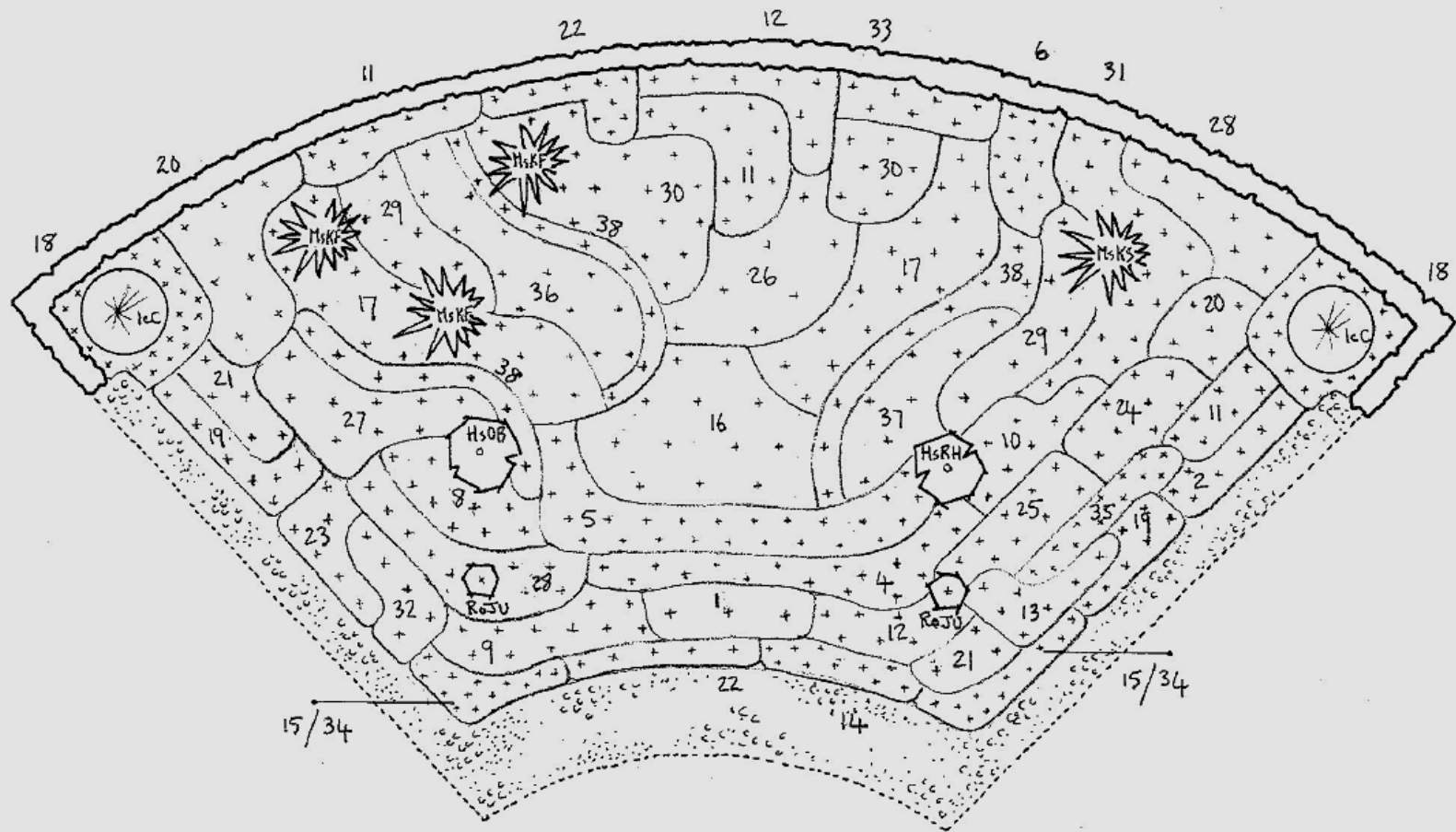

Project: Unwins Fountain, Sandford Park, Cheltenham  
 Title: Detailed Planting Proposals : Quadrants 1 and 2 facing South and East  
 Scale: approx. 1:50 (Do not scale from this drawing)  
 Date: August 2018  
 Linda Thomas CMLI JFRI MA Landscape Consultant ©

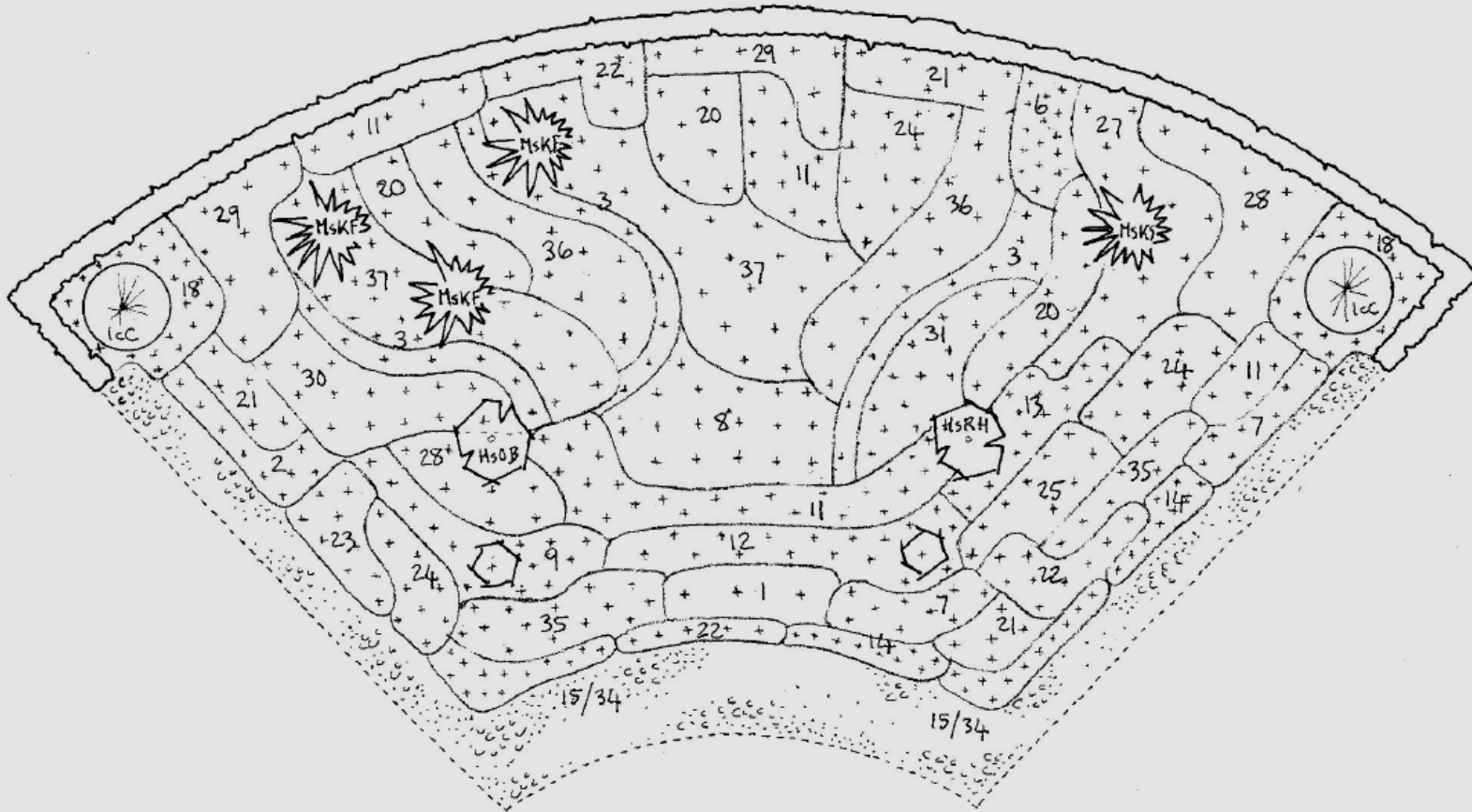

Project: Unwins Fountain, Sandford Park, Cheltenham  
 Title: Detailed Planting Proposals : Quadrants 3 and 4 facing North and West  
 Scale: approx. 1:50 (Do not scale from this drawing)  
 Date: August 2018  
 Linda Thomas CML JFRI MA Landscape Consultant ©

## Unwins Fountain, Sandford Park: List of Plant Species

PLANT SPECIES	Number on plan	AGM	Plant type	Bee friendly	Hardiness	Colour	Seasonal Interest	Growth Habit	Evergreen
T tree S shrub H herbaceous perennial G ornamental grass B bulb Fs feature specimen						X = yes O = No			
Agapanthus 'Loch Hope'	1	X	H	O	H6	dark blue	June-Aug	clump	0
Alchemilla mollis	2	X	H	X	H7	yellow	June-Sept	clump	0
Anemone x hybrida 'Honorine Jobert'	3	X	H	X	H7	white	Sept-Oct	clump	0
Aster amellus 'King George'	4	X	H	X	H7	violet blue	Sept-Oct	bushy	0
Aster x frikartii 'Monch'	5	X	H	X	H7	violet blue	Sept-Oct	bushy	0
Astrantia 'Ruby Star'	6	X	H	O	H7	dark red	Sept-Oct	clump	0
Bergenia 'Silberlicht'	7	X	H	X	H6	white	Mar -May	clump	X
Campanula lactiflora 'Loddon Anna'	8	X	H	X	H7	soft pink	June-Aug	clump	0
Campanula lactiflora 'Prichards Variety'	9	X	H	X	H7	violet blue	June-Aug	bushy	0
Cirsium rivulare 'Atropurpureum'	10	X	H	X	H7	deep red	June-Sept	upright	0
Cercis siliquastrum 'Bodnant'	CsB	X	T	X	H5	purple	Mar -May	bushy	0
Echinacea purpurea 'Ruby Giant'	11	X	H	X	H5	deep pink	June-Aug	bushy	0
Echinops ritro 'Veitchs Blue'	12	X	H	X	H7	violet blue	June-Aug	upright	0
Eryngium x tripartitum	13	X	H	X	H5	violet blue	June-Aug	clump	0
Geranium sanguineum var striatum 'Splendens'	14	X	H	X	H7	pale lilac	Mar -May	prostrate	0
Geranium 'Johnsons Blue'	15	O	H	X	H7	lavender	Mar -May	clump	0
Helenium 'Dunkle Pracht'	16	X	H	X	H7	orange	June-Aug	upright	0
Helenium 'Ring of Fire'	17	X	H	X	H7	red/yellow	June-Aug	clump	0
Hibiscus syriacuse 'Oiseau Bleu' standard	HsOB	X	SFs	O	H5	blue	June-Aug	bushy	0
Hibiscus syriacuse 'Red Heart' standard	HsRH	X	SFs	O	H5	white	June-Aug	bushy	0
Ilex crenata 'Convexa' topiary cone 140cm	IcC	X	TFs	O	H6	dark green lv	all year	topiary	X
Ilex crenata 'Convexa' instant hedging	IcC	X	S	O	H6	hedging	all year	bushy	X
Lamium maculatum 'Elisabeth de Haas'	18	O	H	X	H7	purple	all year	prostrate	X
Lavandula angustifolia 'Imperial Gem'	19	X	S	X	H5	lavender	June-Aug	bushy	X
Leucanthemum x superbum 'Aglaia'	20	X	H	X	H5	white	June-Sept	bushy	0
Miscanthus sinensis 'Kleine Fontaine'	MsKF	X	G Fs	O	H6	grass	June-Sept	clump	0
Miscanthus sinensis 'Kleine Silberspinne'	MsKS	X	G Fs	O	H6	grass	June-Sept	clump	0
Monarda 'Violet Queen'	21	X	H	X	H4	violet	June-Aug	clump	0

## Unwins Fountain, Sandford Park: List of Plant Species

<i>Nepeta racemosa</i> 'Walkers Low'	22	X	H	X	H7	deep mauve	June-Aug	bushy	0
<i>Nepeta x faassenii</i>	23	X	H	X	H7	light blue	June-Aug	bushy	0
<i>Penstemon</i> 'Evelyn'	24	X	H	X	H4	pale pink	June-Aug	clump	semi
<i>Penstemon</i> 'Sour Grapes'	25	X	H	X	H4	purple	June-Aug	clump	semi
<i>Perovskia</i> 'Blue Spire'	26	X	S	X	H5	violet blue	Aug-Oct	bushy	0
<i>Phlox paniculata</i> 'Blue Paradise' scented	27	X	H	X	H7	violet blue	June-Aug	bushy	0
<i>Phlox paniculata</i> 'Rosa Pastell' scented	28	X	H	X	H7	pale pink	June-Aug	bushy	0
<i>Rosmarinus officinalis</i> 'Miss Jessops Upright'	RoJU	X	S Fs	X	H4	light blue	June-Aug	bushy	X
<i>Rudbeckia fulgida</i> 'Goldsturm'	29	X	H	X	H6	deep yellow	June-Aug	clump	0
<i>Salvia x sylvestris</i> 'Mainacht'	30	X	H	X	H7	deep violet	June-Aug	clump	0
<i>Salvia nemorosa</i> 'Ostfriesland'	31	X	H	X	H7	violet blue	July-Nov	bushy	0
<i>Sedumtelephium</i> 'Purple Emperor'	32	X	H	X	H7	purple lvs	June-Dec	clump	0
<i>Sedum (hylotelephium)</i> 'Herbstfreude'	33	X	H	X	H7	pink brown	June-Dec	clump	0
<i>Stachys byzantina</i>	34	O	H	X	H7	silver lv	all year	mat	X
<i>Stachys officinalis</i> 'Hummelo'	35	X	H	X	H7	purple pink	June-Aug	upright	semi
<i>Symphotrichum pilosum</i> 'Monte Cassino'	36	X	H	X	H7	white	Aug-Oct	bushy	0
<i>Symphotrichum cordifolium</i> 'Chieftain'	37	X	H	X	H7	light mauve	Aug-Oct	bushy	0
<i>Verbena bonariensis</i>	38	X	H	X	H4	purple	June-Aug	upright	0



Unwins Fountain, Sandford Park: List of Plant Species

PLANT SPECIES	Number	Aspect	Height m	Spread m	Planting	Quantity	Quantity	Total No
	on Plan				Distance	Beds 1&2	Beds 3&4	Plants
T tree S shrub H herbaceous perennial G ornamental grass B bulbs		Fs feature specimen						
Agapanthus 'Loch Hope'	1	full sun	1.0-1.5	0.1-0.5	0.5m	6	6	12
Alchemilla mollis	2	sun or shade	0.1-0.5	0.1-0.5	0.4m	14	18	32
Anemone x hybrida 'Honorine Jobert'	3	sun/partial shade	1.0-1.5	0.5-1.0	0.6m	0	50	50
Aster amellus 'King George'	4	full sun	0.5-0.6	0.1-0.5	0.4m	34	0	34
Aster x frikartii 'Monch'	5	full sun	0.5-0.9	0.1-0.5	0.4m	54	0	54
Astrantia 'Ruby Star'	6	sun/partial shade	0.5-1.0	0.1-0.5	0.3m	26	30	56
Bergenia 'Silberlicht'	7	sun/partial shade	0.1-0.5	0.1-0.5	0.4m	0	32	32
Campanula lactiflora 'Loddon Anna'	8	sun/partial shade	1.0-1.5	0.1-0.5	0.4m	18	34	52
Campanula lactiflora 'Prichards Variety'	9	sun/partial shade	0.5-0.75	0.1-0.5	0.4m	22	26	48
Cirsium rivulare 'Atropurpureum'	10	full sun	1.0-1.5	0.1-0.5	0.4m	14	0	14
Cercis siliquastrum 'Bodnant'	CsB	sun/partial shade	8.0-12.0	8.0 plus	as advised	0	0	as advised
Echinacea purpurea 'Ruby Giant'	11	sun/partial shade	0.5-0.9	0.1-0.5	0.4m	50	92	120
Echinops ritro 'Veitchs Blue'	12	full sun	0.5-1.0	0.1-0.5	0.4m	28	34	62
Eryngium x tripartitum sea holly	13	full sun	0.5-1.0	0.1-0.5	0.3m	14	30	44
Geranium sanguineum var striatum 'Splendens'	14	sun/partial shade	0.1-0.5	0.1-0.5	0.3m	22	36	58
Geranium 'Johnsons Blue'	15	sun/partial shade	0.1-0.5	0.5-1.0	0.3m	24	24	48
Helenium 'Dunkle Pracht'	16	full sun	1.0-1.2	0.1-0.5	0.5m	26	0	26
Helenium 'Ring of Fire'	17	full sun	1.0-1.5	0.1-0.5	0.5m	64	0	64
Hibiscus syriacuse 'Oiseau Bleu' standard	HsOB	full sun	1.5-2.5	0.1-0.5	as shown	2	2	8
Hibiscus syriacuse 'Red Heart' standard	HsRH	full sun	1.5-2.5	1.5-2.5	as shown	2	2	8
Ilex crenata 'Convexa' topiary cone 140cm Ht	IcC	sun/shade	3.0-4.0	1.0-1.5	as shown	4	4	8
Ilex crenata 'Convexa' instant hedging (lin m)	IcC	sun/shade	0.5m	0.5m	as shown	40	40	80
Lamium maculatum 'Elisabeth de Haas'	18	partial/full shade	0.1cm	0.1-0.5	0.3m	76	76	152
Lavandula angustifolia 'Imperial Gem'	19	full sun	0.1-0.5	0.5-1.0	0.4m	28	0	28
Leucanthemum x superbum 'Aglaiia'	20	sun/partial shade	0.6-0.9	0.5-0.75	0.5m	28	40	68
Miscanthus sinensis 'Kleine Fontaine'	MsKF	full sun	1.2-1.5	max 0.5	as shown	6	6	12
Miscanthus sinensis 'Kleine Silberspinne'	MsKS	full sun	1.5-1.8	max 0.5	as shown	2	2	4
Monarda 'Violet Queen'	21	sun/partial shade	0.5-1.0	0.1-0.5	0.5m	16	34	50

Unwins Fountain, Sandford Park: List of Plant Species

PLANT SPECIES	Number	Aspect	Height m	Spread m	Planting	Quantity	Quantity	Total No
	on Plan				Distance	Beds 1&2	Beds 3&4	Plants
Nepeta racemosa 'Walkers Low'	22	sun/partial shade	0.5-0.75	0.1-0.5	0.4m	28	42	70
Nepeta x faassenii catmint	23	sun/partial shade	0.1-0.5	0.1-0.5	0.4m	14	18	32
Penstemon 'Evelyn'	24	sun/partial shade	0.5-1.0	0.1-0.5	0.4m	18	66	84
Penstemon 'Sour Grapes'	25	sun/partial shade	0.5-1.0	0.1-0.5	0.4m	18	18	36
Perovskia 'Blue Spire'	26	full sun	1.0-1.2	0.5-1.0	0.6m	14	0	14
Phlox paniculata 'Blue Paradise' scented	27	sun/partial shade	1.0-1.2	0.1-0.5	0.5m	18	26	44
Phlox paniculata 'Rosa Pastell' scented	28	sun/partial shade	0.5-1.0	0.5-1.0	0.5m	32	32	64
Rosmarinus officinalis 'Miss Jessops Upright'	RoJU	full sun	1.0-1.5	1.0-1.5	as shown	4	4	8
Rudbeckia fulgida 'Goldsturm'	29	sun/partial shade	0.5-0.6	0.1-0.5	0.6m	20	32	52
Salvia x sylvestris 'Mainacht'	30	full sun	0.5-1.0	0.1-0.5	0.4m	48	30	78
Salvia nemorosa 'Ostfriesland'	31	full sun	0.75 max	0.45 max	0.4m	34	28	62
Sedum telephium 'Purple Emperor'	32	full sun	0.5 max	0.1-0.5	0.4m	10	0	10
Sedum (hylotelephium) 'Herbstfreude'	33	full sun	0.5-0.6	0.1-0.5	0.4m	14	0	14
Stachys byzantina	34	full sun	0.1-0.5	0.5-1.0	0.3m	24	24	48
Stachys officinalis 'Hummelo'	35	sun/partial shade	0.5-0.6	0.1-0.5	0.4m	26	44	70
Symphyotrichum pilosum 'Monte Cassino'	36	sun/partial shade	0.5-0.8	0.1-0.5	0.5m	26	48	74
Symphyotrichum cordifolium 'Chieftain'	37	sun/partial shade	1.0-1.5	0.1-0.5	0.5m	14	84	98
Verbena bonariensis	38	full sun	1.5-2.5	0.1-0.5	0.3m	48	0	48