

KEY

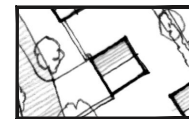

Housing



Garages



Existing Trees Retained



Existing Hedgerow Retained

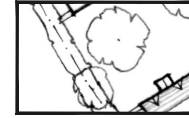

Proposed Tree Planting

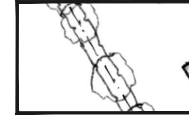

Proposed Hedgerows

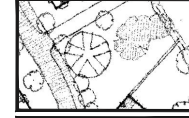

Open Space with LAP

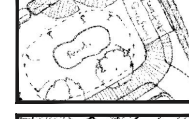

SuD's Pond and Pump Station



Primary Road



Secondary Road

Site Name:
Land off Kidnappers Lane, Leckhampton

Drawing Number:
300.P.3

Revision:
K

Drawing Title:
Illustrative Masterplan

Drawn By:
POK

Date:
20.08.18

Scale:
1:500@A3

Robert Hitchins
The Complete Development Solution

The Manor, Boddington, Cheltenham, Gloucestershire, GL51 0TJ
Tel: 01242 680694
www.robert-hitchins.co.uk

DO NOT SCALE FROM THIS PLAN